

Definition: all metals self-locking riveting nut, with locking slot

Threading: standard to ISO 965-2

Characteristic and performance test: for steel ISO 898-2 / ISO 2320
for stainless steel ISO 3506-2 / NFE 25035

d	s	J ₀ + 0,05	B	C	sheet thickness	Ø Boring
M 4	8,00	6,74	5,30	1,60	1,50	6,55
				2,20	2,00	à
				2,60	2,50	6,65
M 6	11,00	8,90	7,00	2,20	2,00	8,70
				2,60	2,50	à
				3,40	3,00	8,80
M 8	14,00	10,50	9,80	2,60	2,50	10,30
				3,40	3,00	à
				4,20	4,00	10,40

Sizes: The sheet thicknesses were given as examples, please contact us for other thicknesses

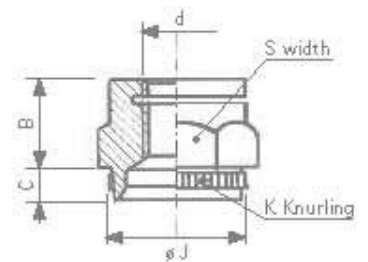

Assembly instruction

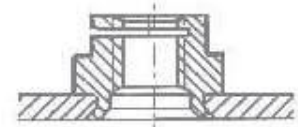

ESF riveting nut

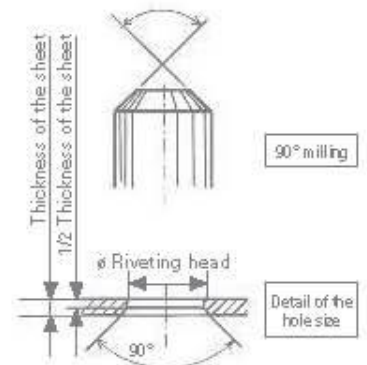

Quality class	Classification	Range of application
Class 8 steel / Grade 5	QV	Self color -50° C +300° C ^{d)}
Stainless steel A4-80	ZH	Corrosive atmosphere -200° C +400° C ^{d)}

^{d)} Values are only given as an indication

Surface treatment (standard to ROHS requirements)			
Electrolytic coating (steel)	Yellow	ZJ	ISO 4042
	White Lanthane ® Finish	ZL	400 h
	White Lanthane ® Finish + Top coat	ZF	600 h
Zinc lamellar (steel)	600 h to 1000 h salt spray		on request
Antigalling (stainless steel)	Stanal ® 400	ST	
	Sherardisation (NF EN 13811)	SH	
Self Color		BT	

Example of ordering code

	Type	Diam X pitch	Class	Protection	
classification	ESF	Ø60 100	QV	ZL	26
threading	ESF	M6 X 1,00	8	White Lanthane®	2,6*

*Sheet thickness